

Model UBH16



Description Dump Pumps
 Flow Range To 38 GPM
 Displacements To 3.511 C.I.R.
 Maximum Pressure to 3000 PSI
 Maximum Speed to 2500 RPM
 Rotation A or C
 Bearings Journal
 Construction Aluminum Flange and Cover
 Cast Iron Gear and Valve Housing

Performance Data

PUMP MODELS	SECTION SIZE	DISPLACEMENT/REVOLUTION (Theoretical)					MAXIMUM PRESSURE		MAXIMUM SPEED
		US Gallons	Cubic Inches	Liters	Cubic Centimeters	Imperial Gallons	PSI	BAR	RPM
UBH16	45	.0038	.878	.0144	14.388	.003	3000	207	2500
UBH16	65	.0055	1.270	.0208	20.812	.005	3000	207	2500
UBH16	85	.0072	1.663	.0273	27.252	.006	3000	207	2500
UBH16	100	.0085	1.964	.0321	32.184	.007	3000	207	2500
UBH16	115	.0097	2.241	.0367	36.723	.008	3000	207	2500
UBH16	150	.0127	2.934	.0481	48.080	.011	3000	207	2500
UBH16	180	.0152	3.511	.0575	57.535	.013	3000	207	2500

All data based on SAE 10W oil at 150°F.

CAUTION: "Inlet vacuum" should not exceed 5" Hg at normal operating speed and temperature. Operation of pumps in excess of 5" Hg requires factory approval.

When sizing pumps, refer to the performance charts in the back of the catalog to determine the volumetric efficiency and input horsepower requirements.

How To Order

'A' denotes counterclockwise rotation
 'C' denotes clockwise rotation
 When viewed from drive shaft end

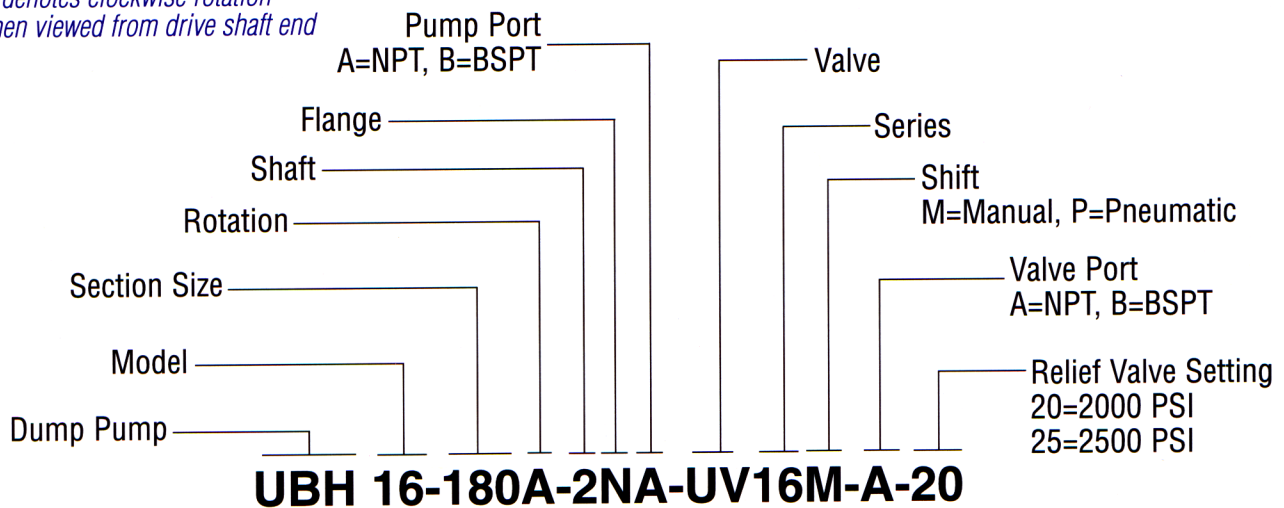

Shafts Available

<p>2 7/8" Dia. 13 Tooth Spline Flat Root Side Fit Torque Limit 184 Lbs. Ft. (249,4 Nm) Available with 'N' & 'S' Flanges Only</p> <p>Spline Data Diametral Pitch 16/32 Pressure Angle 30° No. Of Teeth 13 Minor Dia. 722-733</p>	<p>5 7/8" Straight Shaft Torque Limit 184 Lbs. Ft. (249,4 Nm) Available with 'F' Flanges Only</p>
--	--

Mounting Flanges Available with Manual Valve Operation

<p>F Pad Mount</p> <p>Use Spicer Sleeve Yoke No. 10-3-33X Only</p>	<p>N SAE 'B' 2-Bolt</p>	<p>S P.T.O. Direct Mount</p> <p>Mounting Surface</p>
---	--------------------------------	---

Mounting Flanges Available with Air Valve Operation

<p>F Pad Mount</p> <p>Use Spicer Sleeve Yoke No. 10-3-33X Only</p>	<p>N SAE 'B' 2-Bolt</p>	<p>S P.T.O. Direct Mount</p> <p>Mounting Surface</p>
---	--------------------------------	---

Dimensional Data for Pump with Manual Shift Valve

Mounting Dimensions

MOTOR SIZES	FLANGE TYPE						SHIPPING WEIGHTS (Approx.)	
	F		N		S			
	A	B	A	B	A	B	lbs.	kgs.
UBH16-45	.07 (1,78)	4.67 (118,7)	.32 (8,13)	4.42 (112,3)	1.50 (38,10)	6.23 (158,3)	20.5	9.2
UBH16-65	.14 (3,56)	4.88 (124,0)	.11 (2,79)	4.63 (117,6)	1.71 (43,43)	6.44 (163,6)	20.5	9.2
UBH16-85	.36 (9,15)	5.10 (129,5)	.11 (2,79)	4.85 (123,2)	1.93 (49,02)	6.66 (169,2)	20.5	9.2
UBH16-100	.52 (13,21)	5.26 (133,7)	.27 (6,86)	5.01 (127,3)	2.09 (53,09)	6.82 (173,3)	21.5	9.7
UBH16-115	.68 (17,28)	5.42 (137,7)	.43 (10,92)	5.17 (131,3)	2.25 (57,15)	6.98 (177,3)	21.5	9.7
UBH16-150	1.05 (26,68)	5.79 (147,1)	.80 (20,32)	5.54 (140,7)	2.62 (66,55)	7.35 (186,7)	21.5	9.7
UBH16-180	1.37 (34,81)	6.11 (155,3)	1.12 (28,45)	5.86 (148,8)	2.94 (74,68)	7.69 (195,3)	22.5	10.1

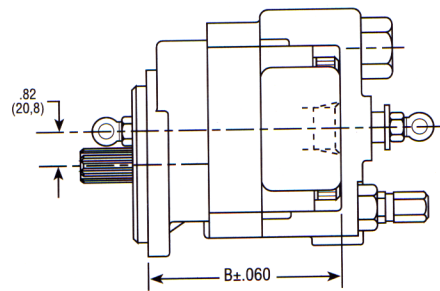
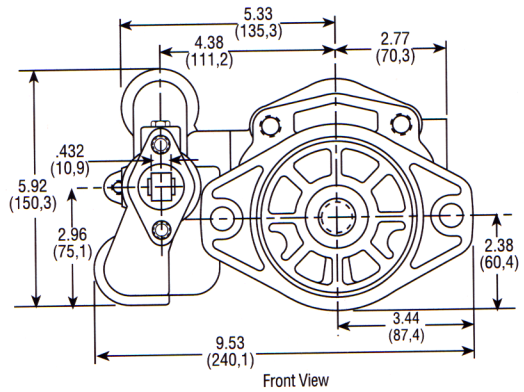
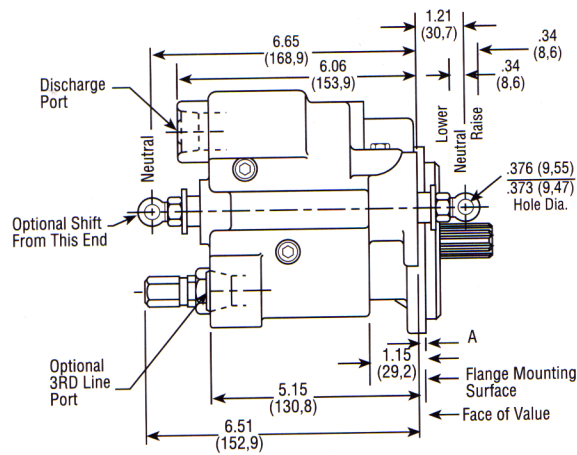

All Views Drawn With 'N' Flange And For Clockwise Rotation

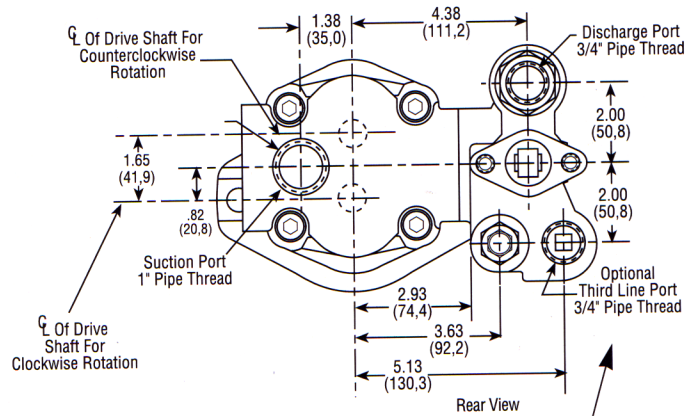

FOR 3-LINE OPERATION:
Remove pipe plug and insert sleeve into this port before installing the fitting.

* These dimensions locate ϕ of bolt pattern only

Dimensional Data for Pump with Air Shift Valve

Mounting Dimensions

MOTOR SIZES	FLANGE TYPE						SHIPPING WEIGHTS (Approx.)	
	F		N		S			
	A	B	A	B	A	B	lbs.	kgs.
UBH16-45	2.01 (51,07)	4.67 (118,7)	2.26 (57,53)	4.42 (112,3)	.44 (11,18)	6.23 (158,3)	20.5	9.2
UBH16-65	1.80 (45,74)	4.88 (124,0)	2.05 (52,09)	4.63 (117,7)	.23 (5,84)	6.44 (163,6)	20.5	9.2
UBH16-85	1.58 (40,15)	5.10 (129,6)	1.83 (46,50)	4.85 (123,2)	.01 (,25)	6.66 (169,2)	20.5	9.2
UBH16-100	1.42 (36,08)	5.26 (133,7)	1.67 (42,43)	5.01 (127,3)	.15 (3,81)	6.82 (173,3)	21.5	9.7
UBH16-115	1.26 (32,02)	5.42 (137,7)	1.51 (38,37)	5.17 (131,4)	.31 (7,88)	6.98 (177,6)	21.5	9.7
UBH16-150	.89 (22,61)	5.79 (147,1)	1.14 (28,97)	5.54 (140,8)	.68 (17,28)	7.35 (186,8)	21.5	9.7
UBH16-180	.57 (14,48)	6.11 (155,3)	.82 (20,84)	5.86 (148,9)	1.00 (25,41)	7.69 (195,4)	22.5	10.1

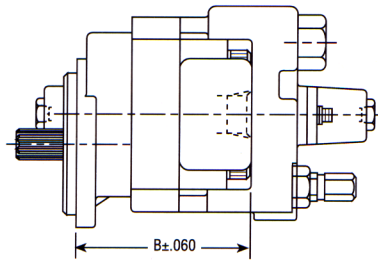
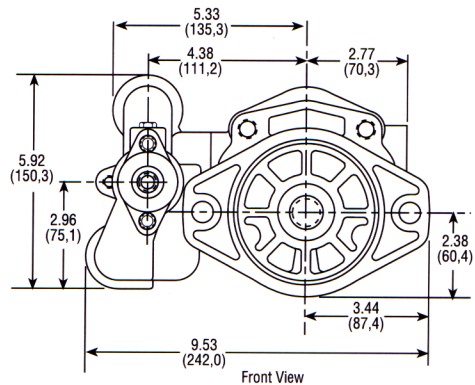
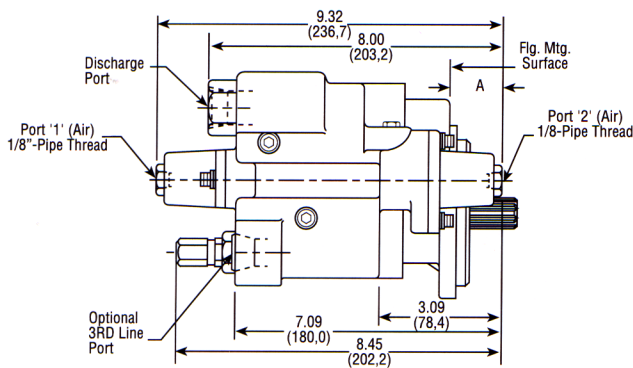

All Views Drawn With 'N' Flange And For Clockwise Rotation

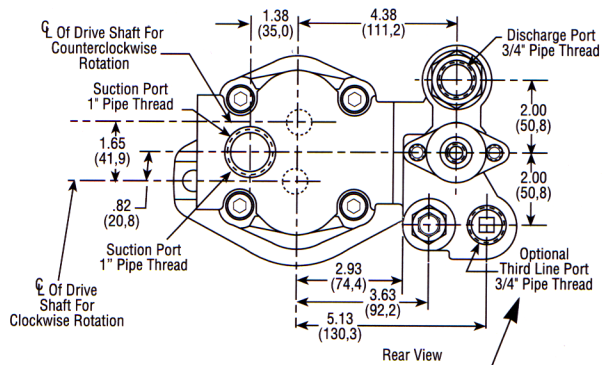

FOR 3-LINE OPERATION:
Remove pipe plug and insert sleeve into this port before installing the fitting.

* These dimensions locate ϕ of bolt pattern only

NOTES:

1—Two-Line Operation:

As shipped, pumps are assembled for two-line operation, i.e., one suction line from the tank, one pressure line to the cylinder. The two-line system is recommended for intermittent operation only.

2—Three-Line Operation:

Uses one suction line from the tank, one return line to the tank, and one pressure line to the cylinder. Use of a filter in the return line requires a check valve between the pump and filter to prevent filter backwash. The three-line system is recommended for continuous operation applications.

3—A minimum of 60 PSI air pressure is required to shift the spool full travel to either raise or lower operating position. Pressure at port "1" (air) moves the spool to raise position. Pressure at port "2" (air) moves the spool to lower position. When vented to atmosphere, ports "1" and "2" allow spring return of the spool to neutral from either raise or lower position.