

Model **HP7-THP7**

Description Gear Pumps
 Flow Range To 116 GPM Per Section (439.1 LTR.)
 Displacements . To 10.74 C.I.R. Per Section (175.99 CC's/REV.)
 Maximum Pressure to 4000 PSI (276 BAR)
 Maximum Speed to 2500 RPM
 Rotation A or C
 Bearings Journal
 Construction Aluminum

Performance Data

PUMP MODEL	SECTION SIZE	DISPLACEMENT/REVOLUTION (Theoretical)					MAXIMUM PRESSURE		MAXIMUM SPEED
		US Gallons	Cubic Inches	Liters	Cubic Centimeters	Imperial Gallons	PSI	BAR	RPM
HP7	250	.0219	5.06	.0829	82.919	.0182	4000	276	2500
HP7	300	.0262	6.05	.0991	99.142	.0218	4000	276	2500
HP7	350	.0306	7.07	.1159	115.857	.0255	4000	276	2500
HP7	400	.0339	7.83	.1283	128.311	.0282	4000	276	2500
HP7	450	.0379	8.75	.1434	143.387	.0316	3700	255	2500
HP7	500	.0422	9.75	.1598	159.774	.0351	3300	228	2500
HP7	550	.0465	10.74	.1760	175.997	.0387	3000	207	2500

All data based on SAE 10W oil.
 Available with Viton seals for use with phosphate ester base fluids.

CAUTION: "Inlet vacuum" should not exceed 5" Hg at normal operating speed and temperature.
 Operation of pumps in excess of 5" Hg requires factory approval.

When sizing pumps, refer to the performance charts in the back of the catalog to determine the volumetric efficiency and input horsepower requirements.

How To Order

'A' denotes counterclockwise rotation
 'C' denotes clockwise rotation
 When viewed from drive shaft end



HP7-250A-2D

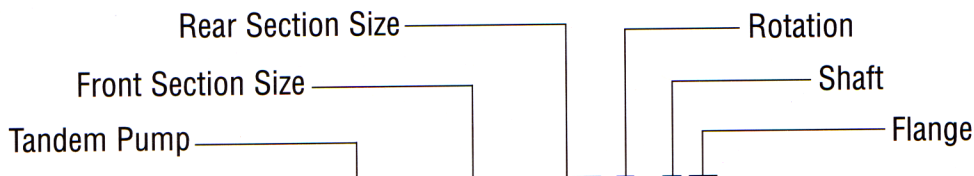

THP7-250-250A-2D

Note: Add prefix 'V' to pump model number (VHP7) (VTHP7) when ordering pumps with Viton Seals for use with phosphate ester base fluids.

Shafts Available

1 1-1/4" 14 Tooth Spline
Flat Root Side Fit
 Torque Limit 655 Lb. Ft. (888,0 Nm)

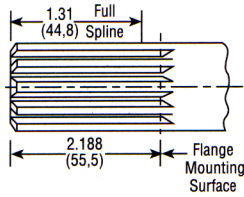

Spline Data
 Diametral Pitch 12/24
 Pressure Angle 30°
 No. Of Teeth 14

2 1-3/4" 13 Tooth Spline
Flat Root Side Fit
 Torque Limit 1800 Lb. Ft. (2440,4 Nm)

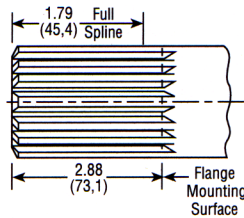

Spline Data
 Diametral Pitch 8/16
 Pressure Angle 30°
 No. Of Teeth 13

3 1-1/4" Straight Shaft for SINGLE Units Only
Flat Root Side Fit
 Torque Limit 655 Lb. Ft. (880,0 Nm)

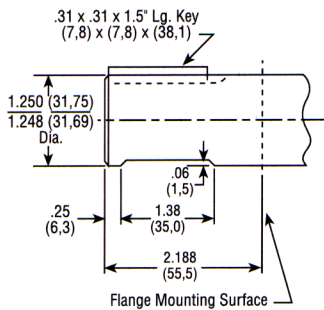

3 1-3/4" Straight Shaft for TANDEM Units Only
Flat Root Side Fit
 Torque Limit 1800 Lb. Ft. (2440,4 Nm)

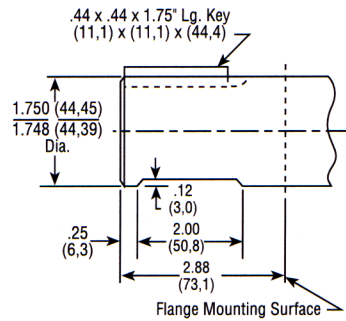

Mounting Flanges Available

D SAE 'C' 2- & 4 Bolt

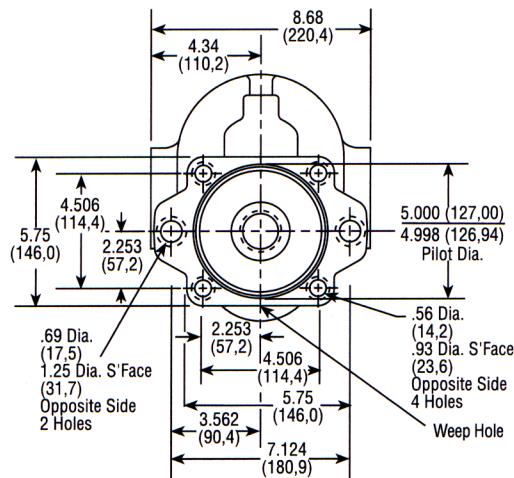

Dimensional Data

Mounting Dimensions

SIZE	A	B	C	D
HP7-250 A & C	7.26 (184,4)	7.76 (197,1)	9.82 (249,4)	7.76 (197,1)
HP7-300 A & C	7.49 (190,2)	7.99 (202,9)	10.05 (255,2)	7.99 (202,9)
HP7-350 A & C	7.71 (195,8)	8.21 (208,5)	10.27 (260,8)	8.21 (208,5)
HP7-400 A & C	7.89 (200,4)	8.39 (213,1)	10.45 (265,4)	8.39 (213,1)
HP7-450 A & C	8.10 (205,7)	8.60 (218,4)	10.66 (270,7)	8.60 (218,4)
HP7-500 A & C	8.32 (211,3)	8.82 (224,0)	10.88 (276,3)	8.82 (224,0)
HP7-550 A & C	8.54 (216,9)	9.04 (229,6)	11.10 (281,9)	9.04 (229,6)

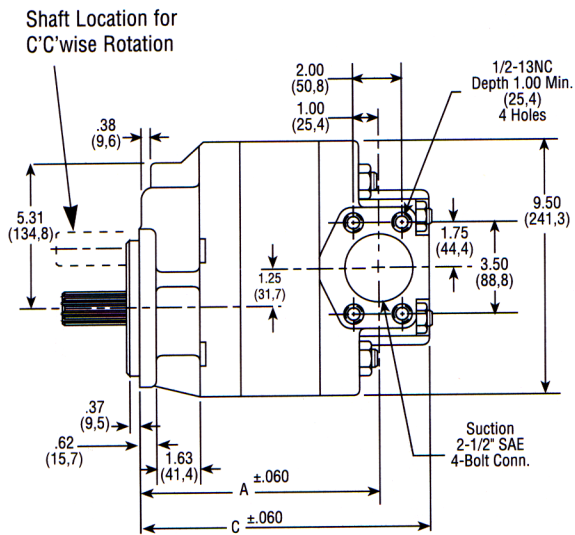
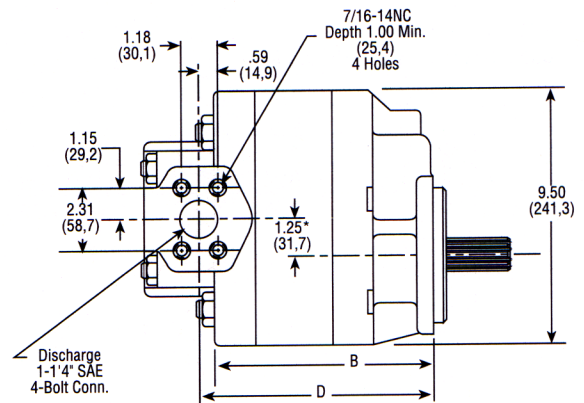

Dimensional Data

Mounting Dimensions

COMBINATIONS AVAILABLE	A	B	C	D	E
THP7-250 - 250 A & C	8.14 (206,7)	17.02 (432,3)	19.58 (497,3)	7.38 (187,4)	17.52 (445,0)
THP7-300 - 250 A & C	8.36 (212,3)	17.24 (437,8)	19.80 (502,9)	7.60 (193,0)	17.74 (450,5)
THP7-300 - 300 A & C	8.36 (212,3)	17.46 (443,4)	20.02 (508,5)	7.60 (193,0)	17.96 (456,1)
THP7-350 - 250 A & C	8.58 (212,3)	17.46 (443,4)	20.02 (508,5)	7.82 (198,6)	17.96 (456,1)
THP7-350 - 300 A & C	8.58 (212,3)	17.68 (449,0)	20.24 (514,0)	7.82 (198,6)	18.18 (461,7)
THP7-350 - 350 A & C	8.58 (212,3)	17.90 (454,6)	20.46 (519,6)	7.82 (198,6)	18.40 (467,3)
THP7-400 - 250 A & C	8.76 (222,5)	17.64 (448,0)	20.20 (513,0)	8.00 (203,2)	18.14 (460,7)
THP7-400 - 300 A & C	8.76 (222,5)	17.86 (453,6)	20.42 (518,6)	8.00 (203,2)	18.36 (466,3)
THP7-400 - 350 A & C	8.76 (222,5)	18.08 (459,2)	20.64 (524,2)	8.00 (203,2)	18.58 (471,9)
THP7-400 - 400 A & C	8.76 (222,5)	18.26 (463,8)	20.82 (528,8)	8.00 (203,2)	18.76 (476,5)
THP7-450 - 250 A & C	8.97 (227,8)	17.86 (453,6)	20.42 (518,6)	8.21 (208,5)	18.36 (466,3)
THP7-450 - 300 A & C	8.97 (227,8)	18.08 (454,2)	20.64 (524,2)	8.21 (208,5)	18.58 (471,9)
THP7-450 - 350 A & C	8.97 (227,8)	18.30 (464,8)	20.86 (529,8)	8.21 (208,5)	18.80 (477,5)
THP7-450 - 400 A & C	8.97 (227,8)	18.47 (469,1)	21.03 (534,1)	8.21 (208,5)	18.97 (481,8)
THP7-450 - 450 A & C	8.97 (227,8)	18.68 (474,4)	21.24 (539,4)	8.21 (208,5)	19.18 (487,1)
THP7-500 - 250 A & C	9.20 (233,6)	18.08 (459,2)	20.64 (524,2)	8.44 (214,3)	18.58 (471,9)
THP7-500 - 300 A & C	9.20 (233,6)	18.30 (464,8)	20.86 (529,8)	8.44 (214,3)	18.80 (477,5)
THP7-500 - 350 A & C	9.20 (233,6)	18.52 (470,4)	21.08 (535,4)	8.44 (214,3)	19.02 (483,1)
THP7-500 - 400 A & C	9.20 (233,6)	18.70 (474,9)	21.26 (540,0)	8.44 (214,3)	19.20 (487,6)
THP7-500 - 450 A & C	9.20 (233,6)	18.92 (480,5)	21.48 (545,5)	8.44 (214,3)	19.42 (493,2)
THP7-500 - 500 A & C	9.20 (233,6)	19.14 (486,1)	21.70 (551,1)	8.44 (214,3)	19.64 (498,8)
THP7-550 - 250 A & C	9.42 (239,2)	18.30 (464,8)	20.86 (529,8)	8.66 (219,9)	18.80 (477,5)
THP7-550 - 300 A & C	9.42 (239,2)	18.52 (470,4)	21.08 (535,4)	8.66 (219,9)	19.02 (483,1)
THP7-550 - 350 A & C	9.42 (239,2)	18.74 (475,9)	21.30 (541,0)	8.66 (219,9)	19.24 (488,6)
THP7-550 - 400 A & C	9.42 (239,2)	18.92 (480,5)	21.48 (545,5)	8.66 (219,9)	19.42 (493,2)
THP7-550 - 450 A & C	9.42 (239,2)	19.14 (486,1)	21.70 (551,1)	8.66 (219,9)	19.64 (498,8)
THP7-550 - 500 A & C	9.42 (239,2)	19.36 (491,7)	21.92 (556,2)	8.66 (219,9)	19.86 (504,4)
THP7-550 - 550 A & C	9.42 (239,2)	19.58 (497,3)	22.14 (562,3)	8.66 (219,9)	20.08 (510,0)

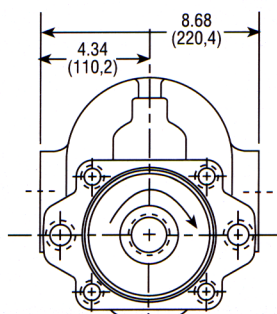

SHOWN FOR CLOCKWISE ROTATION

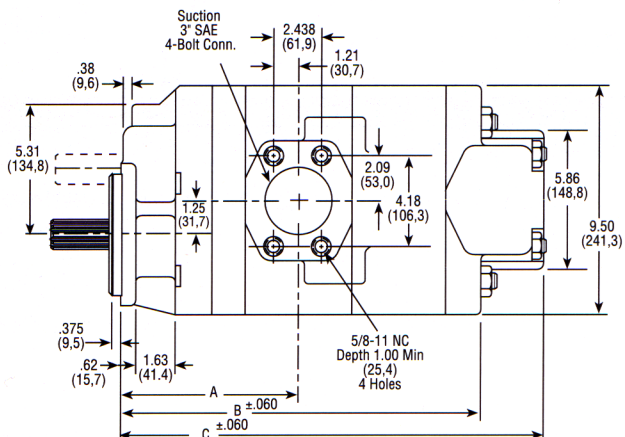
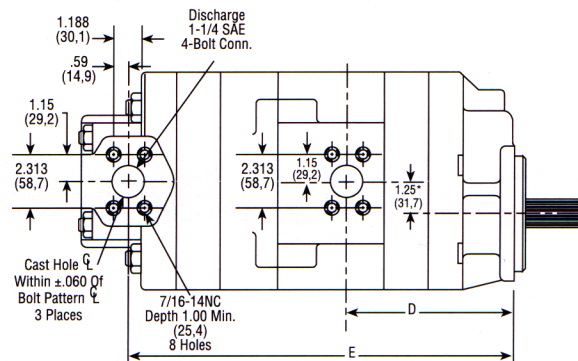

* These dimensions locate ϕ of bolt pattern only

SAE 4-Bolt connectors are available. See Accessory Section