

**Catalog Series**  
**J416A**                      **J417A**  
**or**                                      **or**  
**MS24593**                      **MS24423**

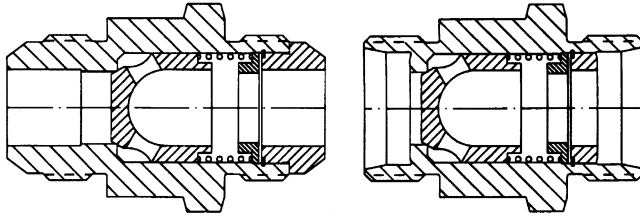

**Pressure Range:**

**Working:** 5,000 PSI maximum  
**Proof:** 7,500 PSI  
**Burst:** 12,500 PSI  
**Cracking:** 5 PSI ±3

**Temperature Range:**

-65° to 450° F.

**Internal Leakage:**

Zero above 5 PSI.  
1 drop per minute maximum below 5 PSI.

**Materials:**

**Body and Nose:** 316 stainless steel.  
**Poppet:** 440C stainless steel.  
**Spring:** AMS5688 stainless steel.

**Sizes:**

4, 6, 8, 10, 12, 16.

**Type Ports:**

**FLD:** Flared tube connection SAE 37° MS33656.  
**FLS:** Flareless tube connection MS33514.



**Specifications**

**Service Applications:**

Any liquid compatible with 316SS, and hardened 440 FSS.

**Dimensions**

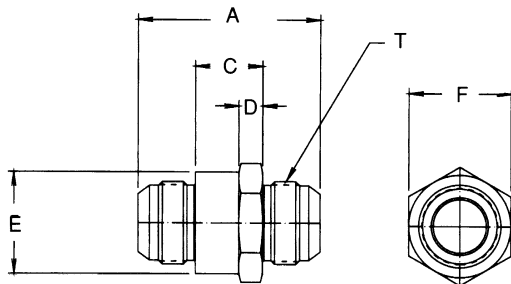

MS24593 or J416A

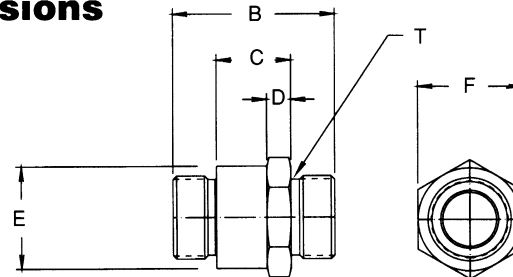

MS24423 or J417A

Valve Size	T	A	B	F	C	D	E	Flow	Weight	Cv
Pipe	Thread	Ref.	Ref.	Hex			Dia.	GPM	Lbs.	Factor
1/4	4 .4375-20UNJF-3A	1.538	1.344	.688	.438	.219	.678	1.2	.07	.38
3/8	6 .5625-18UNJF-3A	1.581	1.407	.813	.469	.250	.803	3.5	.105	.99
1/2	8 .7500-18UNJF-3A	1.814	1.624	1.000	.500	.281	.990	6.0	.195	1.98
5/8	10 .8750-14UNJF-3A	2.047	1.781	1.125	.531	.312	1.115	10.5	.266	2.97
3/4	12 1.0625-12UNJ-3A	2.290	1.938	1.375	.562	.343	1.365	16.0	.450	4.45
1	16 1.3125-12UNJ-3A	2.884	2.438	1.625	±.016	.375	1.615	29.0	.900	7.88

**Interpretation of Valve Number**

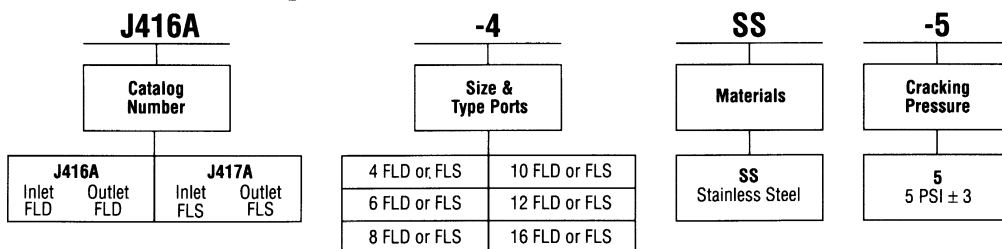

MS Part Number	
Flared	Flareless
MS24593-4	MS24423-4
MS24593-6	MS24423-6
MS24593-8	MS24423-8
MS24593-10	MS24423-10
MS24593-12	MS24423-12
MS24593-16	MS24423-16