

Catalog Series 21400

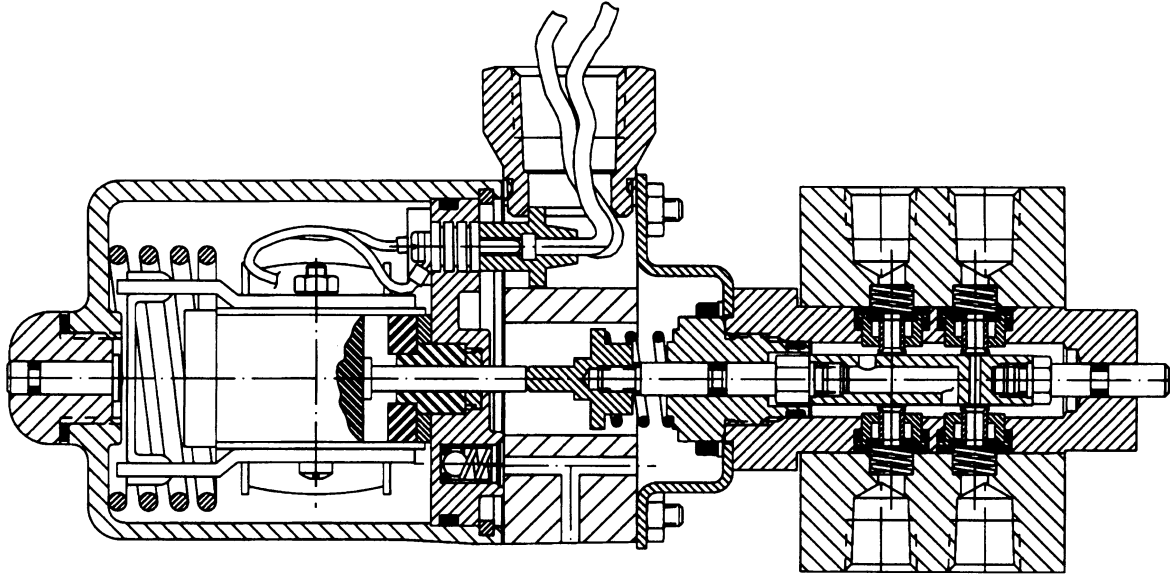

E

Features

- Zero leakage (1 drop per min. per pressurized port).
- Available two-position operating types are: 2-way normally open; 2-way normally closed; 3-way and 4-way.
- Standard valves are interflow.
- Shear-type positive seal.

A.C. Electrical Data

Inrush Current	4.2 Amps Maximum
Holding Current	.85 Amps Maximum
Drop-Out Voltage	Approx. 75% Rated Voltage
Voltage Required to Pull Back After Drop-Out	Approx. 95% Rated Voltage

Specifications

Service Applications:

Lubricated air and hydraulic oil.

Pressure Range:

Working	- Air:	1000 PSI
	- Oil:	6000 PSI
Proof	- Air:	2000 PSI
	- Oil:	9000 PSI
Burst	- Air:	2500 PSI
	- Oil:	15000 PSI

Temperature Range:

-65° to 160° F.
Higher on special order.

Sizes: NPT 1/4, 3/8 (except 4-way).

Type Ports: NPT Pipe Threads AND10053.

CV Factor: .28

Internal Leakage:

Maximum at rated pressure: oil 1 DPM per pressurized port; air 15 bubbles/min.

Mounting: In line.

Materials:

Body: Aluminum alloy, anodized.
Slide: 440 stainless steel.
Seals: 440 stainless steel.
O-Rings: Synthetic rubber.
Back-up Rings: PTFE.

Weights:

2- and 3-way: AC 3 lbs.; DC 5 lbs. 10 oz.;
4-way: AC 3 lbs. 3 oz.; DC 5 lbs. 14 oz.

Operating Time: 25 milliseconds.

Maximum Flow Capacity: 3 GPM.

Maximum Recommended Ambient Temperature: 110° F.

Maximum Outlet Port Back Pressure:
1500 PSI.

Dimensions

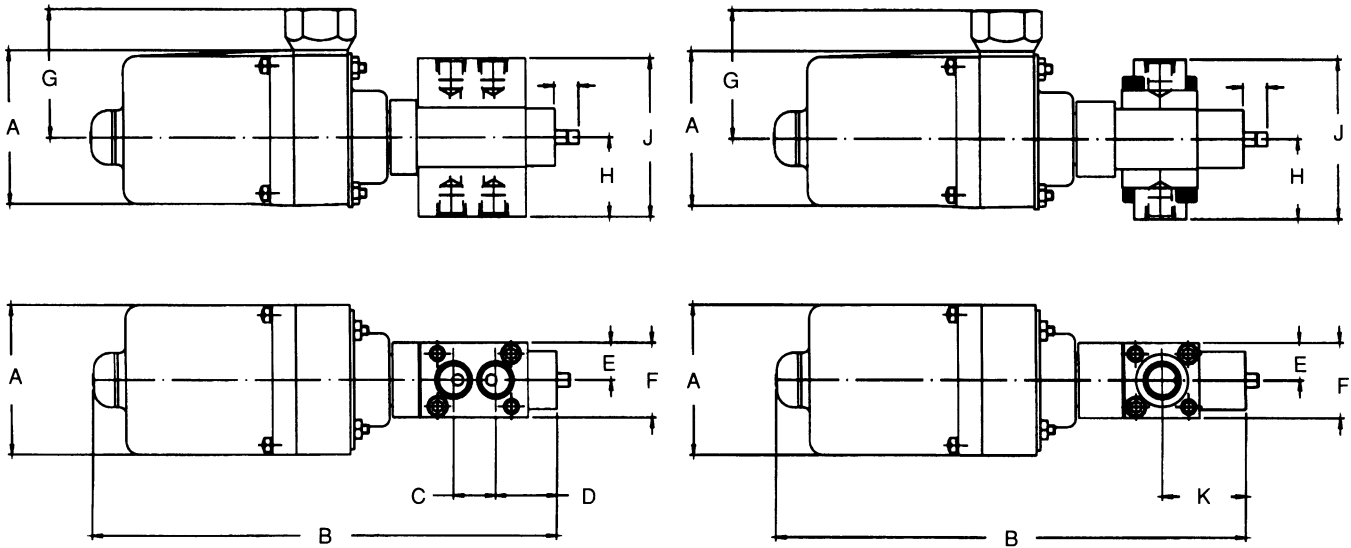

Valve Operator	All Dimensions are in Inches									
	A	B	C	D	E	F	G	H	J	K
A.C. Solenoid	2 ³ / ₄	8 ⁷ / ₁₆	²⁵ / ₃₂	1 ⁵ / ₃₂	¹¹ / ₁₆	1 ³ / ₈	2 ³ / ₈	1 ²⁹ / ₆₄	2 ²⁹ / ₃₂	1 ¹⁷ / ₃₂
D.C. Solenoid	2 ³ / ₄	10 ¹ / ₈	²⁵ / ₃₂	1 ⁵ / ₃₂	¹¹ / ₁₆	1 ³ / ₈	2 ³ / ₈	1 ²⁹ / ₆₄	2 ²⁹ / ₃₂	1 ¹⁷ / ₃₂
Air - Oil Operator	2 ³ / ₄	6 ¹³ / ₁₆	²⁵ / ₃₂	1 ⁵ / ₃₂	¹¹ / ₁₆	1 ³ / ₈	—	1 ²⁹ / ₆₄	2 ²⁹ / ₃₂	1 ¹⁷ / ₃₂



Interpretation of Valve Number

