

D03 Subplate - Nominal 1/2"

SPXX_03GSPSDUAA

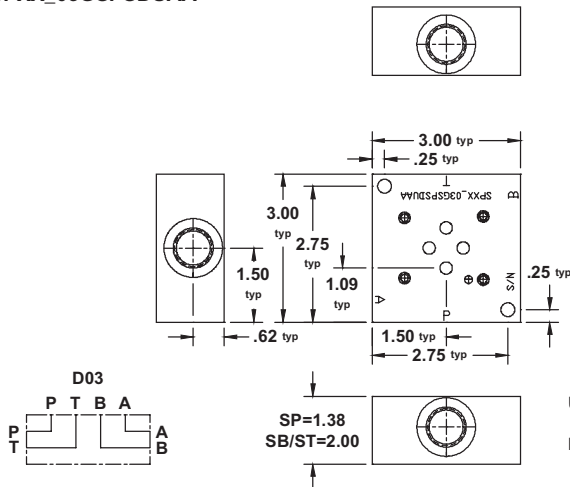

UNC Mounting KIT includes:
2 -1/4"-20 x 2.00"SHCS
Metric Mounting KIT includes:
2 -M6-1.0 x 50mm SHCS

SPXX_03GBPSDUAA

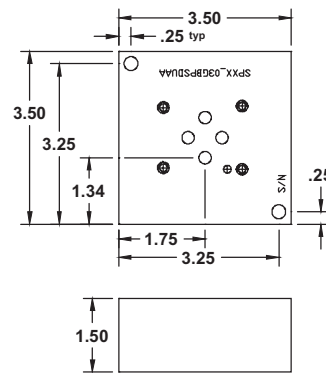

BOTTOM VIEW
SPXX_03GSPSDUAA

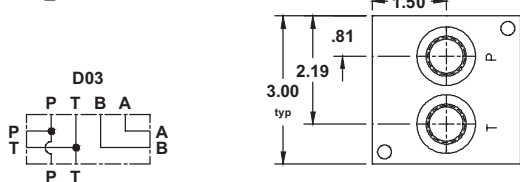

UNC Mounting KIT includes:
2 -1/4"-20 x 2.50"SHCS
2 -Plugs
Metric Mounting KIT includes:
2 -M6-1.0 x 60mm SHCS
2 -Plugs

BOTTOM VIEW
SPXX_03GSPSDUAA

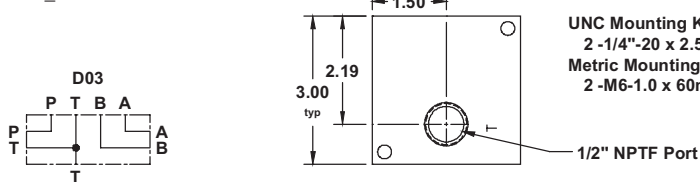

UNC Mounting KIT includes:
2 -1/4"-20 x 2.50"SHCS
Metric Mounting KIT includes:
2 -M6-1.0 x 60mm SHCS

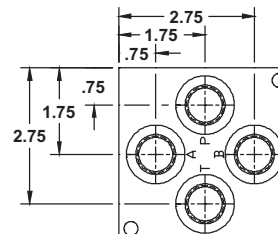

D03
P T B A
P T B A
UNC Mounting KIT includes:
2 -1/4"-20 x 2.00"SHCS
Metric Mounting KIT includes:
2 -M6-1.0 x 50mm SHCS

PART NUMBER SYSTEM

Aluminum D03 Side Ported Subplate with SAE 8 Ports Example: **SPXXA03GSPSDUAA**

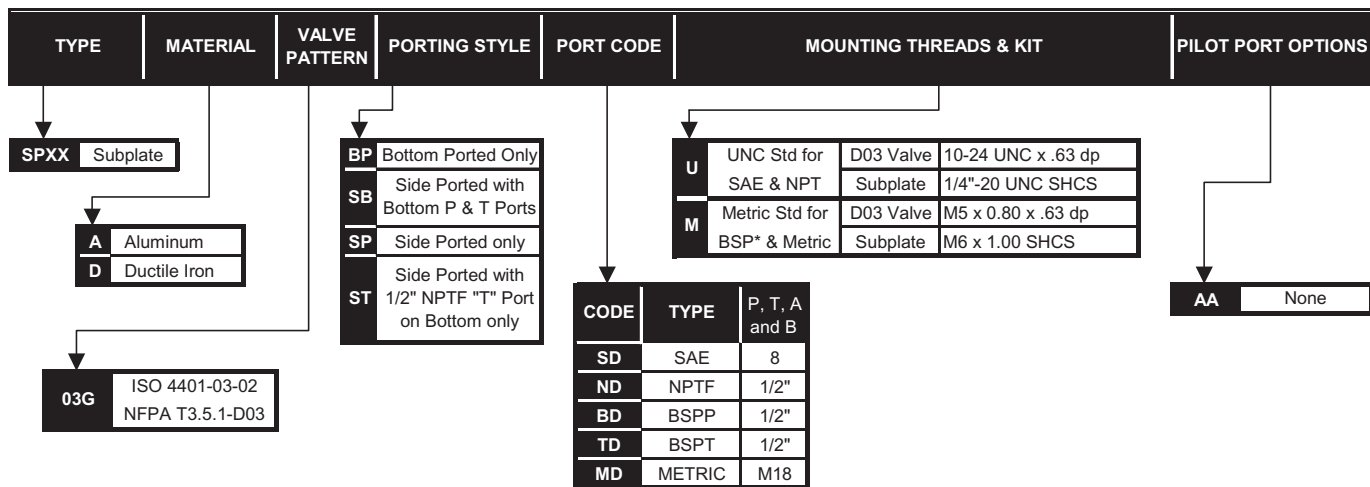

WE RESERVE THE RIGHT TO DISCONTINUE MODELS, OR CHANGE SPECIFICATIONS WITHOUT NOTICE OR INCURRING OBLIGATION

Lynch Products Can Be Modified to Suit Your Application



Lynch MANIFOLDS & VALVE PACKS

D03 Subplate - Nominal 3/4"

4
SUBPLATES

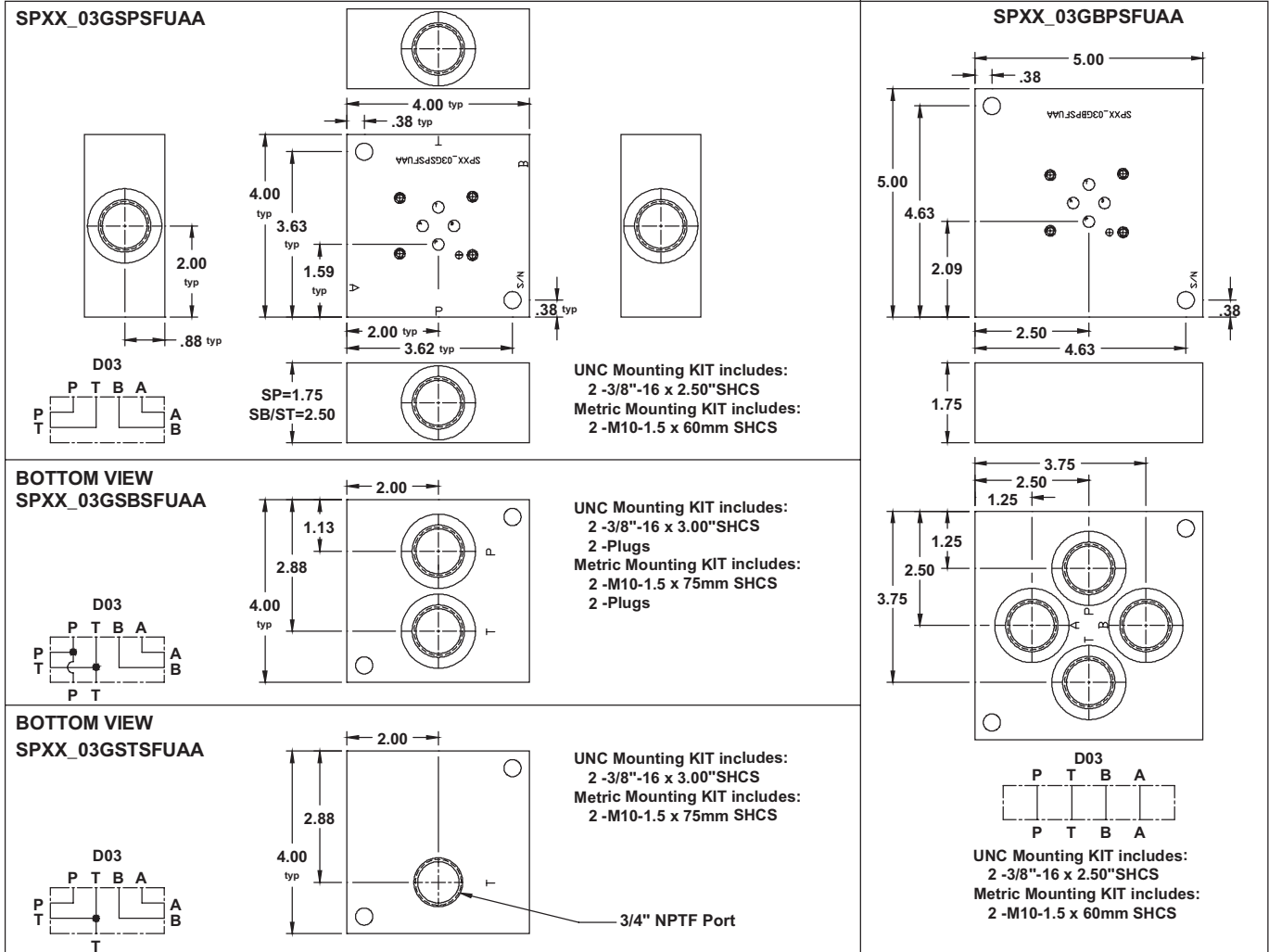

PART NUMBER SYSTEM

Aluminum D03 Side Ported Subplate with SAE 12 Ports Example: **SPXXA03GSPSFUAA**

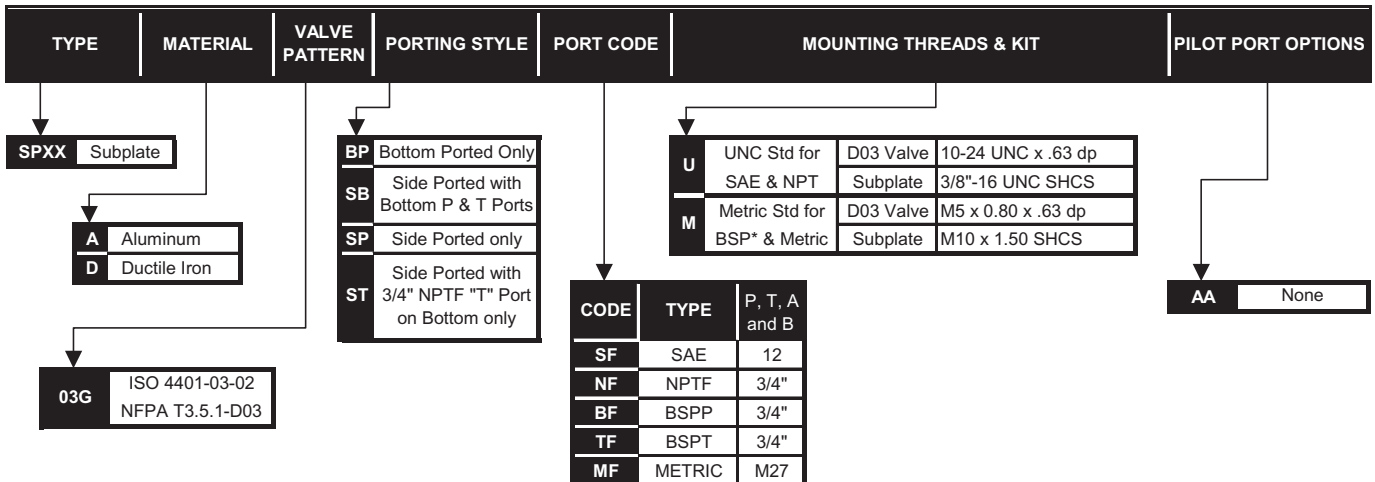

WE RESERVE THE RIGHT TO DISCONTINUE MODELS, OR CHANGE SPECIFICATIONS WITHOUT NOTICE OR INCURRING OBLIGATION

Lynch Products Can Be Modified to Suit Your Application



NFPA
Solutions through motion technology
MEMBER

